

LH4-B816

LH4-B816NP

Lockstitch Button Holer
 Lockstitch Button Holer
 <Clutch-less type>



Specifications

Model	LH4-B816 · LH4-B816NP	
Subclass	-21	-31
Main use	Shirt, blouse, dress, etc.	Underwear, sweater, etc.
Button hole size		
No. of stitches	58-347	
Work clamp lift stroke	13 mm	
Max. sewing thickness	6 mm	
Needle size	SY1906 (Schmetz 1906)	
Max. speed	4,000 rpm	
Stitch patterns	<p>Whip stitch</p> <p>Front Back</p>	<p>Purl stitch</p> <p>Front Back</p>

*Models with a standard pneumatic one-pedal device are also available.

*Whip stitch (plain stitch)

The above stitch pattern in which the upper thread moves over the top and the button thread moves over the bottom of the material in a zigzag pattern is called a “whip” stitch. This pattern is identical to the zigzag pattern of a lock stitch zigzag machine.

*Purl stitch (seal stitch)

The above pattern in which the upper needle thread tension is high and the upper needle follows a straight line through the seam center while the lower thread moves left to right and intertwines with the upper thread is called a “purl” stitch.

Different parts Cutter

[B816, B816NP]

<p>109837-001</p>	<p>107204-001</p>	<p>107200-001</p>	<p>S03278-001</p>	<p>107205-001</p>	<p>S25641-001</p>
<p>107207-001</p>	<p>S25642-001</p>	<p>109838-001</p>	<p>107210-001</p>	<p>S01271-001</p>	<p>S01272-001</p>
<p>S01273-001</p>	<p>S03280-001</p>	<p>S01274-001</p>	<p>S01275-001</p>	<p>S01276-001</p>	<p>S35630-001</p>
<p>S30294-001</p>		<p>143780-001</p>			

Upper clamping foot assembly

Upper clamping foot

[B816, B816NP]

159072-101 16 mm (-2) 147113-001	158982-101 16 mm R (-2) 159581-001	159074-101 25 mm (-2) 159579-001
159217-101 25 mm R (-2) 159582-001	159076-101 32 mm R (-2) 159580-001	159764-101 16 mm RS (-2) 159761-001
159765-101 25 mm RS (-2) 159762-001	159766-101 32 mm RS (-2) 159763-001	S01466-101 16 mm (-3) 14136-001
S01467-101 25 mm (-3) 144630-001	S01468-101 32 mm (-3) 144632-001	

Needle plate

[B816, B816NP]

159278-001 1.2 mm (-2)	S01469-001 1.2 mm (-3)	159279-001 1.4 mm (-2)
159280-001 1.6 mm (-2)	159758-001 1.2 mm S (-2)	159759-001 1.4 mm S (-2)
159760-001 1.6 mm S (-2)	S01269-001 1.2 mm S (-2)	S08006-001 1.2 mm (-3)
Plastic plate 156612-001	Plastic plate S01270-001	

Change gear

[B816, B816NP]

No. of stitches	Change gear L	Change gear R	No. of stitches	Change gear L	Change gear R
347	(54)141388-000	(22)141372-001	127	(36)141379-000	(40)141381-000
306	(52)141387-000	(24)141373-001	114	(34)141378-000	(42)141382-000
271	(50)141386-000	(26)141374-000	103	(32)141377-000	(44)141383-000
242	(48)141385-000	(28)141375-000	92	(30)141376-000	(46)141384-000
216	(46)141384-000	(30)141376-000	82	(28)141375-000	(48)141385-000
194	(44)141383-000	(32)141377-000	73	(26)141374-000	(50)141386-000
174	(42)141382-000	(34)141378-000	65	(24)141373-001	(52)141387-000
157	(40)141381-000	(36)141379-000	58	(22)141372-001	(54)141388-000
141	(38)141380-000	(38)141380-000			

Motor pulley and V-belt selection

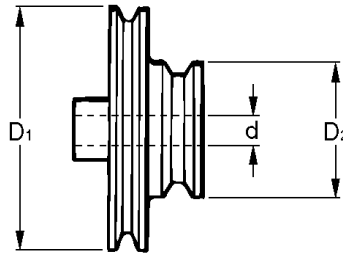

Machine speed	Frequency	Motor pulley			High speed V-belt	Low-speed V-belt
		Outside diameter	Core	Parts No.		
4,000	50Hz	D1 = 157.5 D2 = 65.3	d = 14	159632-001	S18707-131 (M31)	S18707-128 (M28)
			d = 15.88	S00396-001		
4,000	60Hz	D1 = 132.2 D2 = 51.7	d = 14	159385-001	S18707-129 (M29)	S18707-127 (M27)
			d = 19.05	S00397-001		
3,600	50Hz	D1 = 142.4 D2 = 64.0	d = 14	159633-001	S18707-130 (M30)	S18707-128 (M28)
			d = 15.88	S00392-001		
			d = 16	S01243-001		
3,600	60Hz	D1 = 119.5 D2 = 54.1	d = 14	159387-001	S18707-128 (M28)	S18707-127 (M27)
			d = 16	S01242-001		
			d = 19.05	S00393-001		
3,200	50Hz	D1 = 127.2 D2 = 63.2	d = 14	159634-001	S18707-129 (M29)	S18707-128 (M28)
			d = 15.88	S00394-001		
			d = 16	S01944-001		
3,200	60Hz	D1 = 106.9 D2 = 56.8	d = 14	159386-001	S18707-127 (M27)	S18707-127 (M27)
			d = 16	S01879-001		
			d = 19.05	S00395-001		
2,800	60Hz	D1 = 91.5 D2 = 56.8	d = 14	S12564-001	S18707-126 (M26)	S18707-127 (M27)