

DT6-B927, B928

/CH1

INSTRUCTION MANUAL

Please read this manual before using the machine.
Please keep this manual within easy reach for quick reference.

PNEUMATIC TYPE CHAIN CUTTER

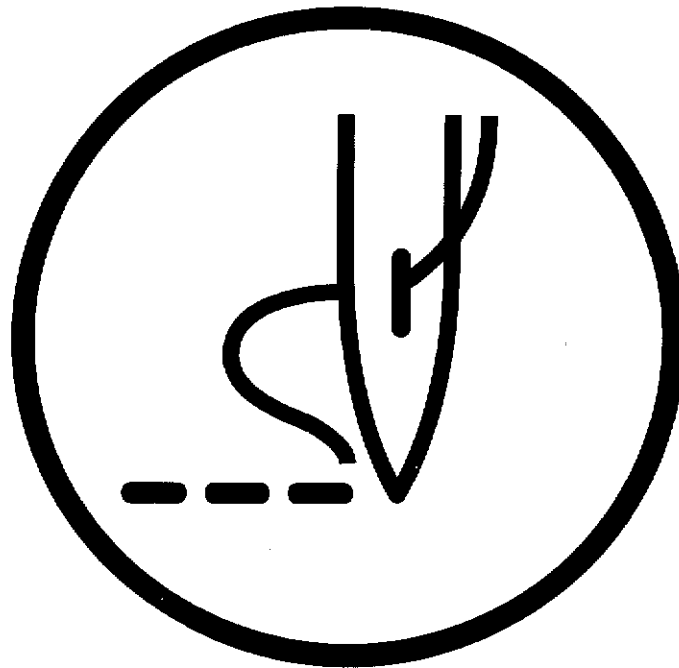

brother[®]

⚠ CAUTION

⊘ Do not connect the power cord until installation is complete, otherwise the machine may operate if the treadle is depressed by mistake, which could result in injury.

[Applicable models] DT6-B927 (models without fixed needle guard), DT6-B928 (models with puller device only)
 [Applications] Thin- to extra-heavy materials

1. INSTALLING THE CHAIN CUTTER

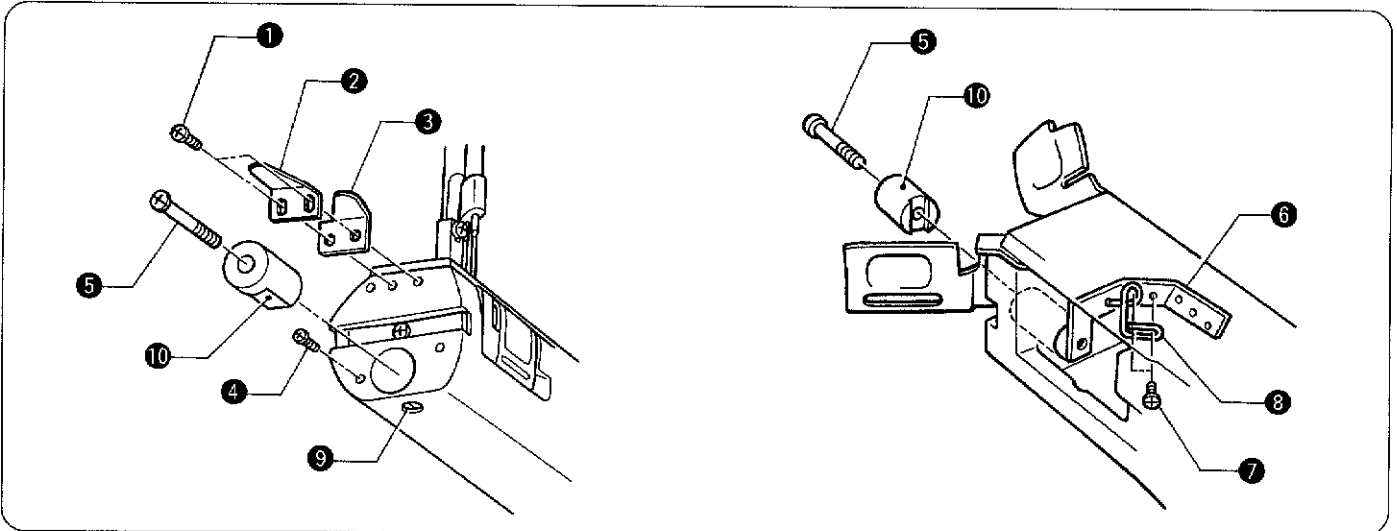

[Removal method]

1. Remove the two screws ①, and then remove the thread trimmer guide plate ② and the thread trimmer ③.
2. Remove the screw ④.
3. Remove the screw ⑤, and then remove the looper thread guide ⑥.
 * For the DT6-B927, remove the two screws ⑦, and then remove the thread guide ⑧.
4. Loosen the set screw ⑨, and then remove the looper thread guide base ⑩.

1. INSTALLING THE CHAIN CUTTER

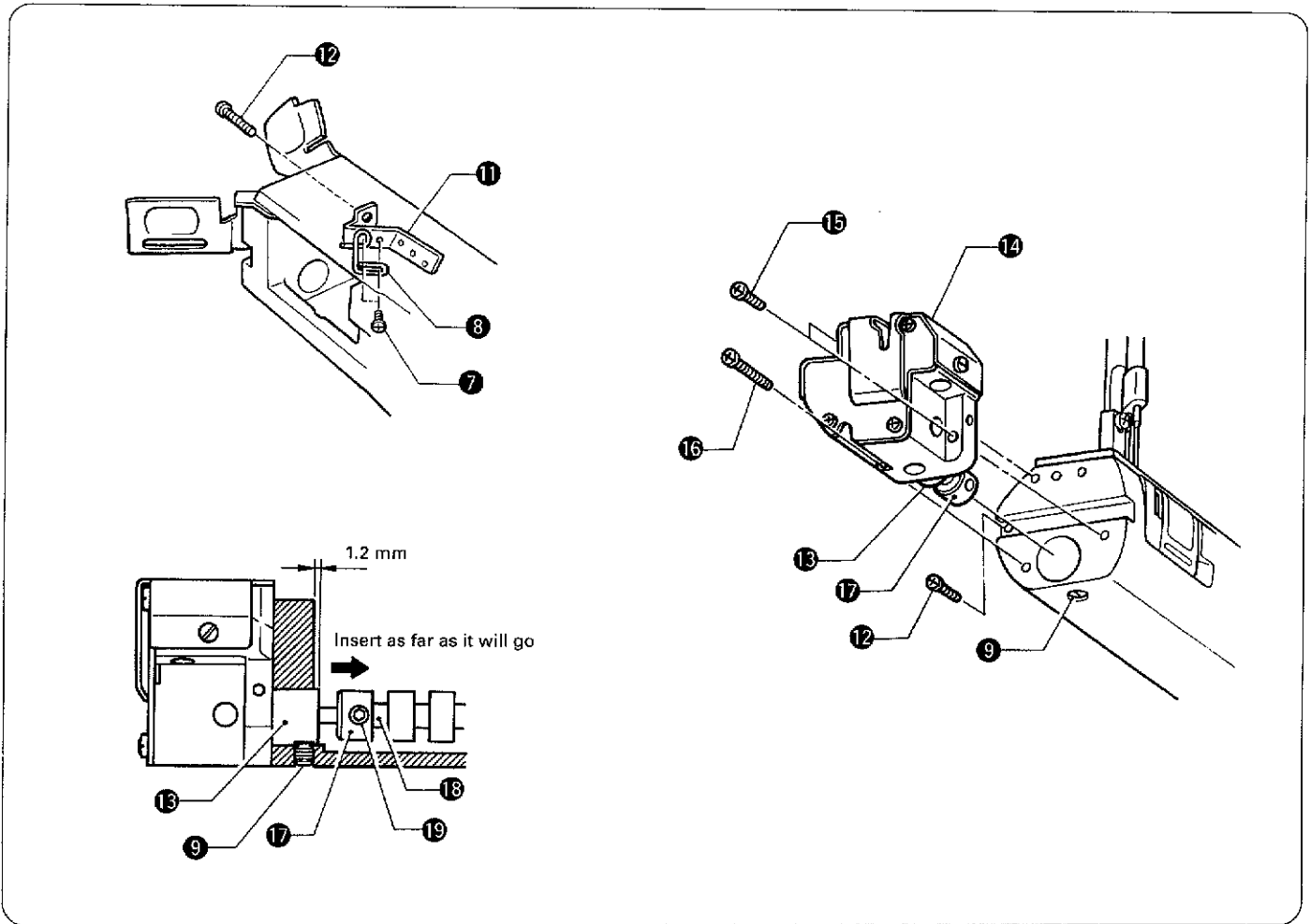

[Installation method]

1. Install the accessory looper thread guide ① to the bed with the screw ⑫.
* For the DT6-B927, install the thread guide ① with the two screws ⑦.
2. Set the joint shaft bushing ⑩ of the chain cutter so that it projects 1.2 mm from the bed, and then tighten the set screw ⑨ in that position.
3. Install the chain cutter ⑭ with the two screws ⑮ and the screw ⑯.
4. Push the joint ⑰ onto the looper shaft ⑬ as far as it will go, and then tighten the two set screws ⑱.
* If the joint ⑰ is not pushed onto the looper shaft ⑬ as far as it will go at this time, the movable knife may not move to the correct position, and the chaining-off thread may not be cut.

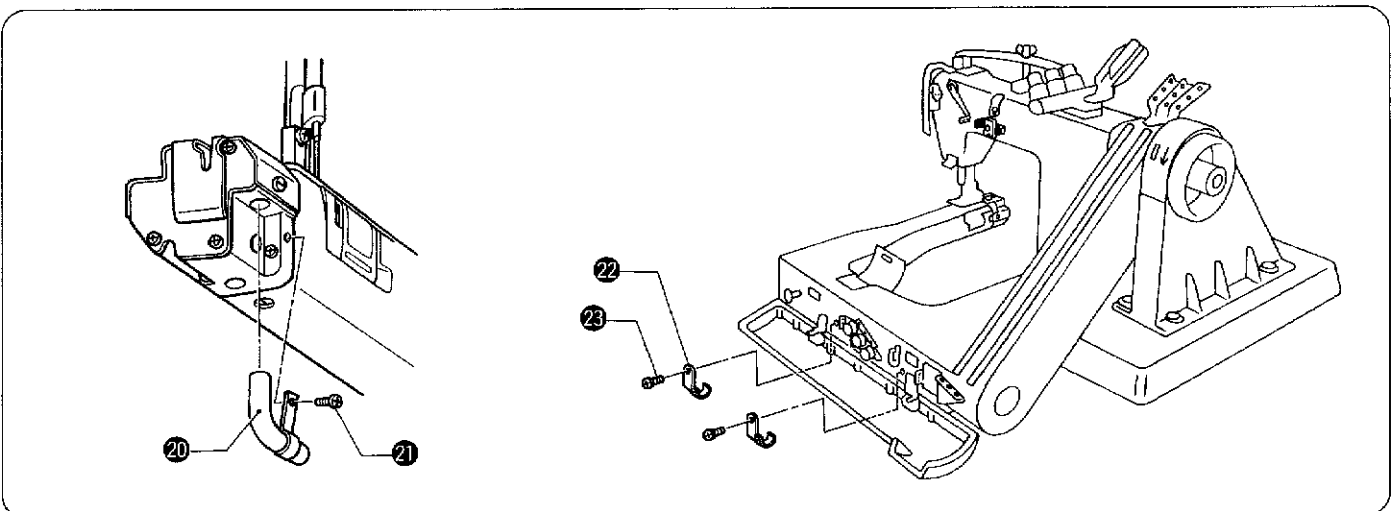

5. Insert the end of the hose joint elbow ⑳ into the hole in the chain cutter, and then tighten it with the screw ㉑.
6. Install the hose set plate ㉒ to the bed with the screw ㉓.

2. CONNECTING THE HOSES

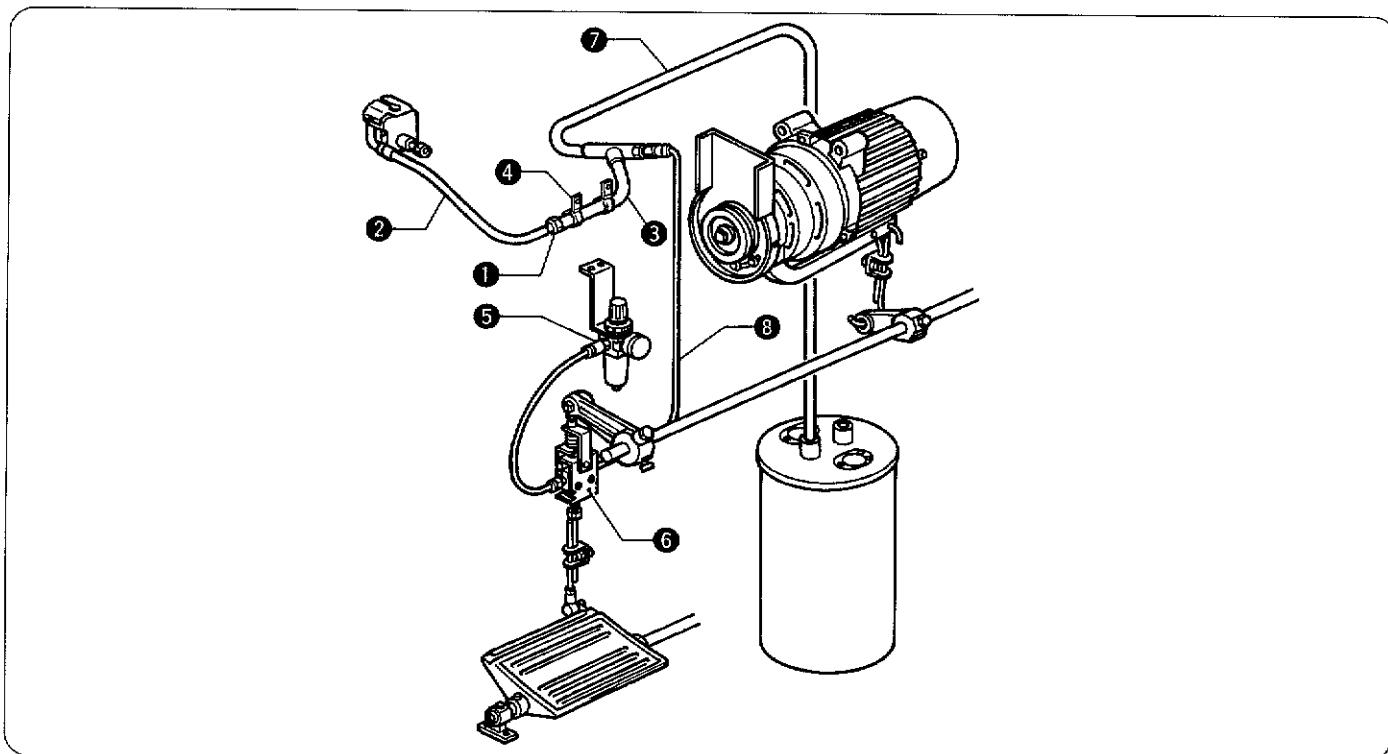

Connect the hose ② and the hose ③ to the hose joint ① and install the hoses ② and ③ to the hose set plate ④. Install the air unit assembly ⑤ and the connecting rod assembly ⑥, and connect the hose ⑦ and the air tube ⑧.

3. ADJUSTING THE AIR INTAKE TIMING AND AIR PRESSURE

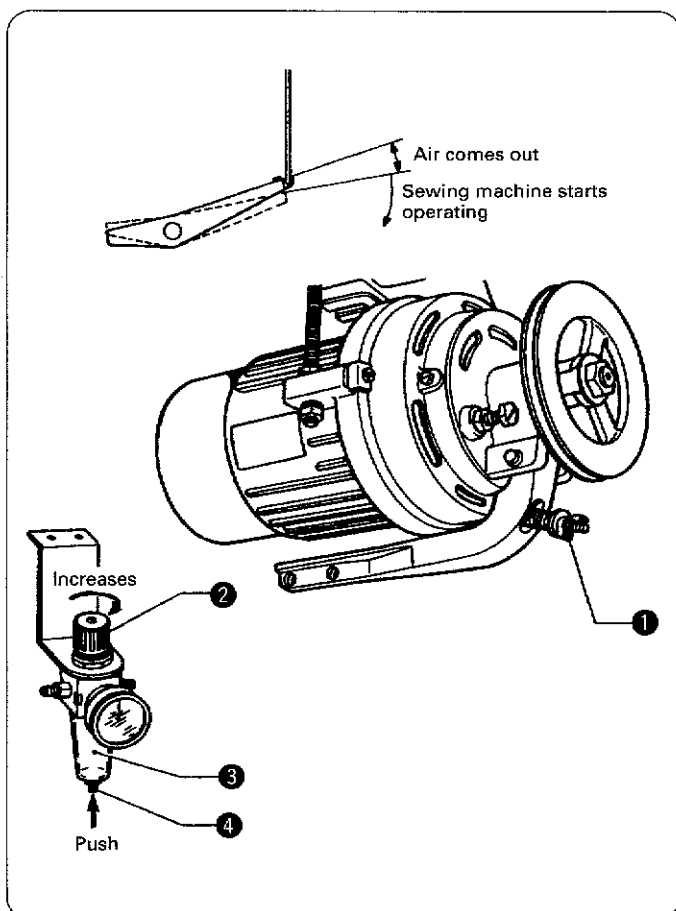

1. Turn the wing nut ① of the clutch lever to adjust so that the air starts coming out at the point just before the machine starts operating or when it starts operating when the treadle is depressed gently.
2. Use the air pressure indicated in the table below.

Material	Air pressure
Thin	0.20 - 0.29 Mpa (2 - 3 kg/cm ²)
Medium-thick and heavy	0.29 - 0.39 Mpa (3 - 4 kg/cm ²)
Extra-heavy	0.39 - 0.49 Mpa (4 - 5 kg/cm ²)

The air pressure increases when the knob ② is turned clockwise. Moreover, if water has collected inside the bottle ③, stop the compressor and push up the drain cock ④ to drain the water.

4. PULLER HEIGHT ADJUSTMENT (MACHINES WITH PULLER)

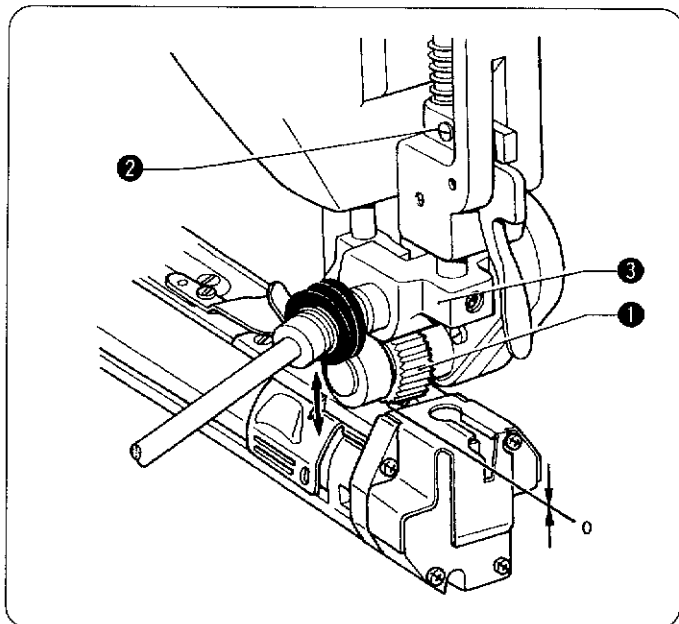

Adjust the height of puller ① so that there is no clearance between the puller and the top of the needle plate. Loosen the set screw ②, and move the puller support ③ up or down so that there is no clearance between the puller and the top of the needle plate. After the adjustment, retighten set screw ②.

5. SEWING

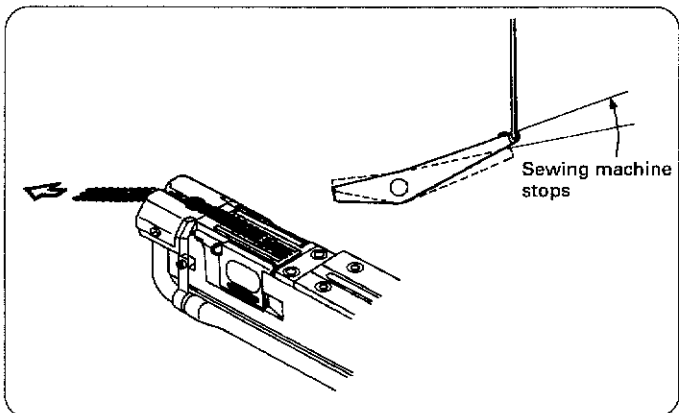

Pull the material downward being sewn so that the chaining-off stitch goes into the groove of the chain cutter. This will allow the chaining-off stitch to be cut. Stop the machine as soon as possible after the chaining-off stitch has been cut.

6. REPLACING THE KNIVES

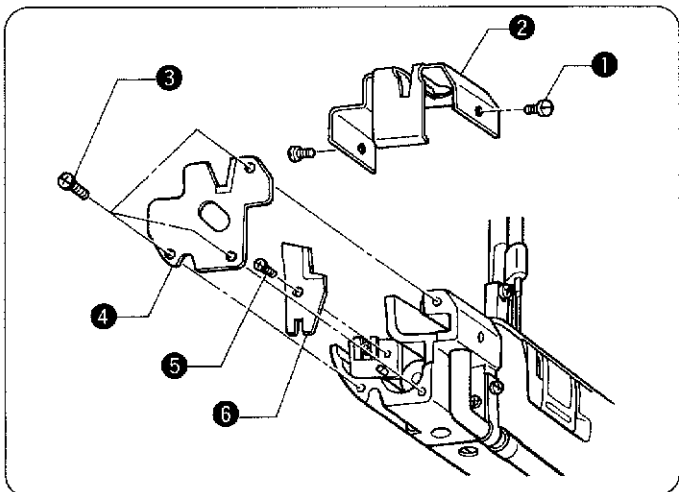

[Removal method]

1. Remove the two screws ①, and then remove the knife cover ②.
2. Remove the three screws ③, and then remove the fixed knife ④.
3. Remove the screw ⑤, and then remove the movable knife ⑥.

* Reverse the above procedure to install.

7. ADJUSTING THE MESHING OF THE MOVABLE KNIFE AND FIXED KNIFE

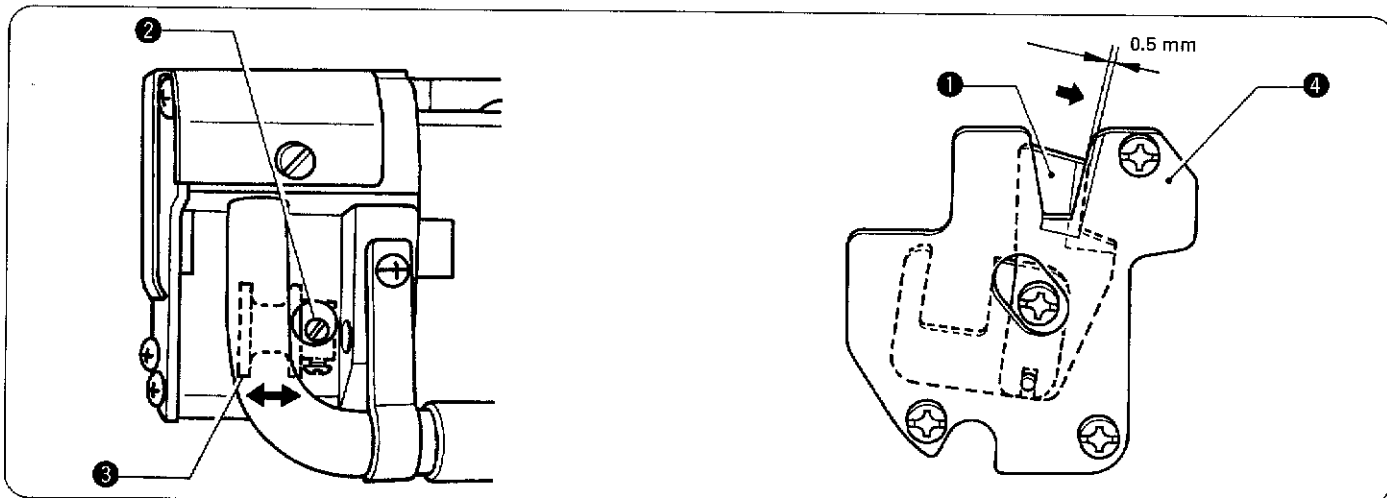

1. Turn the machine pulley to move the movable knife ① all the way in the direction indicated by the arrow.
2. Use a screwdriver or similar tool to turn the joint shaft fork ③ until the screws ② can be seen from the hole in the chain cutter base.
3. Loosen the two screws ②, and then move the joint shaft fork ③ back and forth to adjust so that the edge of the movable knife ① overlaps the fixed knife ④ by 0.5 mm.
4. Tighten the two screws ②.

8. CLOTH PRESSER

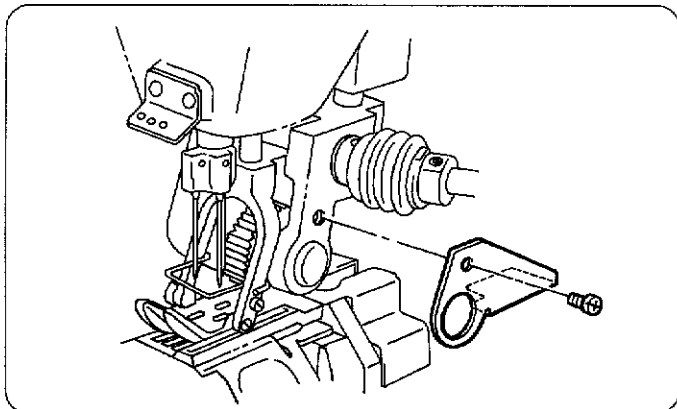

Use the cloth presser with -7 and -8 model specifications of the DT6-B928 to wind the material upward at the sewing start.

* The cloth presser is provided as an option with the chain cutter set.

brother[®]

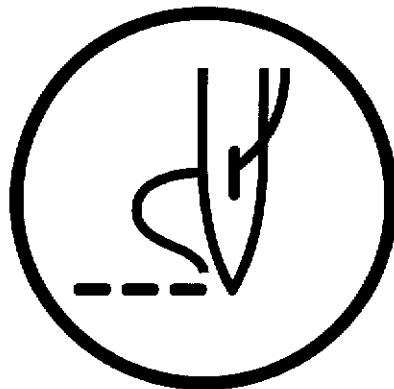

INSTRUCTION MANUAL

BROTHER INDUSTRIES, LTD. NAGOYA, JAPAN

Printed in Japan

118-927, 928
S92927-022
1998.01. B ①