

LS2–B883 Mark II

Single Needle Basting Lock Stitcher
with Thread Trimmer



Specifications

| | - 100 | - 200 |
|------------------------|--|---------------|
| Application | For tacking items such as men's clothing, ladies' clothing and overcoats | |
| Max. speed | 850 rpm | |
| Max. stitch length | Free stitching by manual feed | |
| Needle bar stroke | 38 mm | |
| Thread take-up stroke | 64.6 mm | |
| Height of presser foot | 17.5 mm | |
| Needles | MT × 190 #11 - #16 | |
| Hook | Horizontal large rotary hook (vertical axis) | |
| Thread trimmer | Scissors type (Solenoid) | |
| Thread nipper | – | Solenoid type |
| Table (Standard) | 1,200 (W) × 830 (D) × 760 (H) mm | |

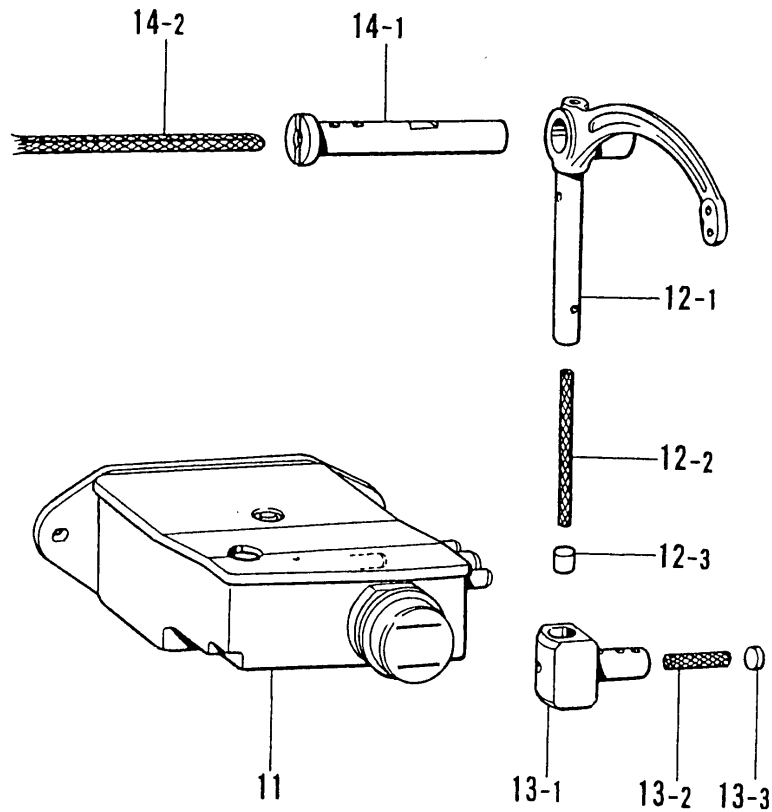

| Ref. No. | Part name | Part code | Q'ty |
|----------|-----------------------------------|------------|------|
| 11 | Oil tank assy | S38417-001 | 1 |
| 12 | Thread take-up assy, L5 | S38405-001 | 1 |
| 12-1 | Thread take-up, L5 | S38395-001 | 1 |
| 12-2 | Wick 4 × 4 (L=40) | S03289-001 | 1 |
| 12-3 | Rubber cap, 4.2 | 142274-009 | 1 |
| 13 | Thread take-up slide block 2 assy | S13160-001 | 1 |
| 13-1 | Thread take-up slide block | S07338-001 | 1 |
| 13-2 | Wick (L=30) | 114693-001 | 1 |
| 13-3 | Pusher | 113024-000 | 1 |
| 14 | Thread take-up shaft assy | S14506-001 | 1 |
| 14-1 | Thread take-up shaft | S07334-001 | 1 |